

### STANDARD GLASS SIZES

### NON REMOVABLE SECURITY TYPE GLAZING BEAD SYSTEM (TYP.)

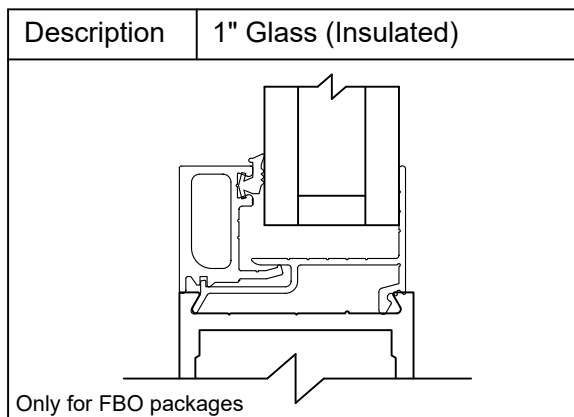
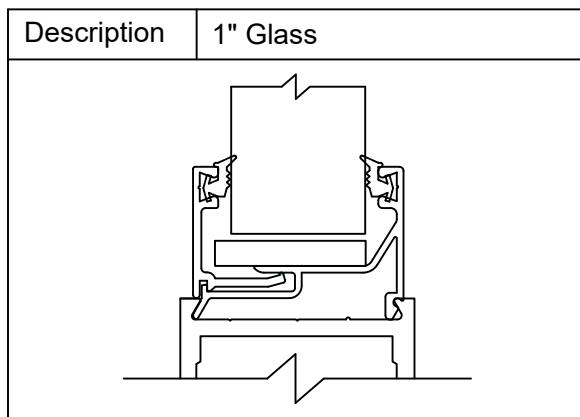
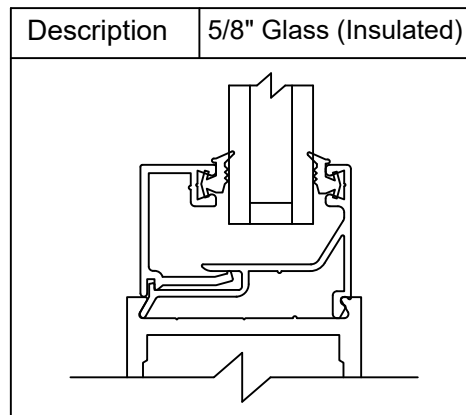
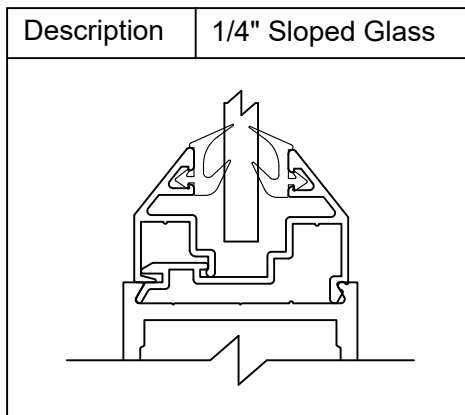
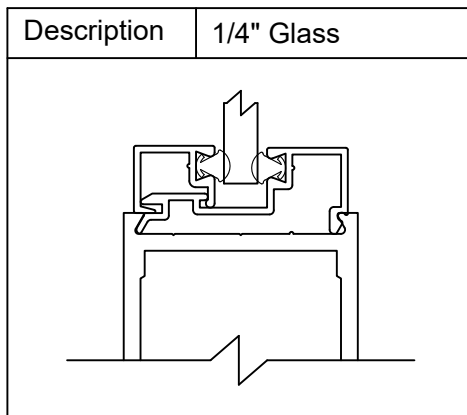

### CGL GLASS SIZES

### HEAT STRENGTHENED SAFETY GLASS (TEMPERED). ASTM APPROVED SEALANT REQUIRED.

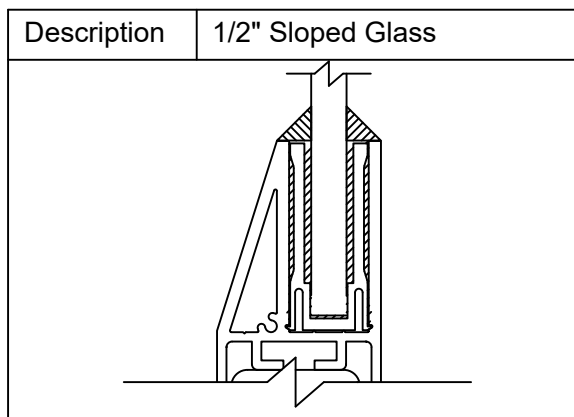
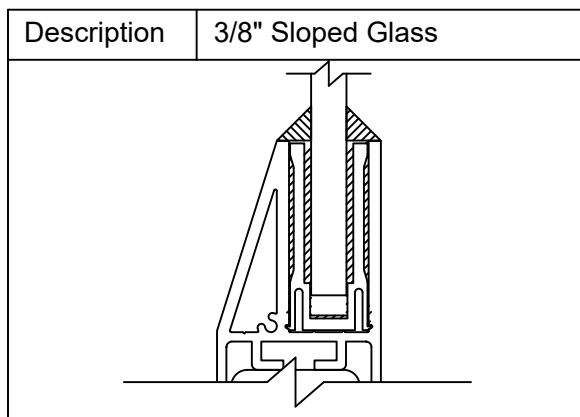

DIMENSIONS FOR 5/8" AND 1" GLASS	NARROW STILE	MEDIUM STILE	WIDE STILE
BI-PART	WIDTH: (OFW/4)-4 3/4" (OFW/4)-[120.7]	WIDTH: (OFW/4)-7 1/2" (OFW/4)-[190.5]	WIDTH: (OFW/4)-9" (OFW/4)-[228.6]
	HEIGHT: (OFH)-16 3/8" (OFH)-[415.9]	HEIGHT: (OFH)-18 9/16" (OFH)-[471.5]	HEIGHT: (OFH)-18 9/16" (OFH)-[471.5]
SINGLE SLIDE	WIDTH: (OFW/2)-5 5/8" (OFW/2)-[142.9]	WIDTH: (OFW/2)-8 3/8" (OFW/2)-[212.7]	WIDTH: (OFW/2)-9 7/8" (OFW/2)-[250.8]
	HEIGHT: (OFH)-16 3/8" (OFH)-[415.9]	HEIGHT: (OFH)-18 9/16" (OFH)-[471.5]	HEIGHT: (OFH)-18 9/16" (OFH)-[471.5]

TABLE NOT APPLICABLE FOR TELESCOPIC PACKAGES

DWG NO. 1022537					
DRN BY	CAT	DATE 07/07/2021	CHK BY SS	DATE 07/07/2021	REV. 1.0 DATE 07/07/2021
			<hr/> <hr/> <hr/>		
			<hr/> <hr/> <hr/>		
			<hr/> <hr/> <hr/>		
			<hr/> <hr/> <hr/>		