

DOOR ELEVATION (viewed from Inside)

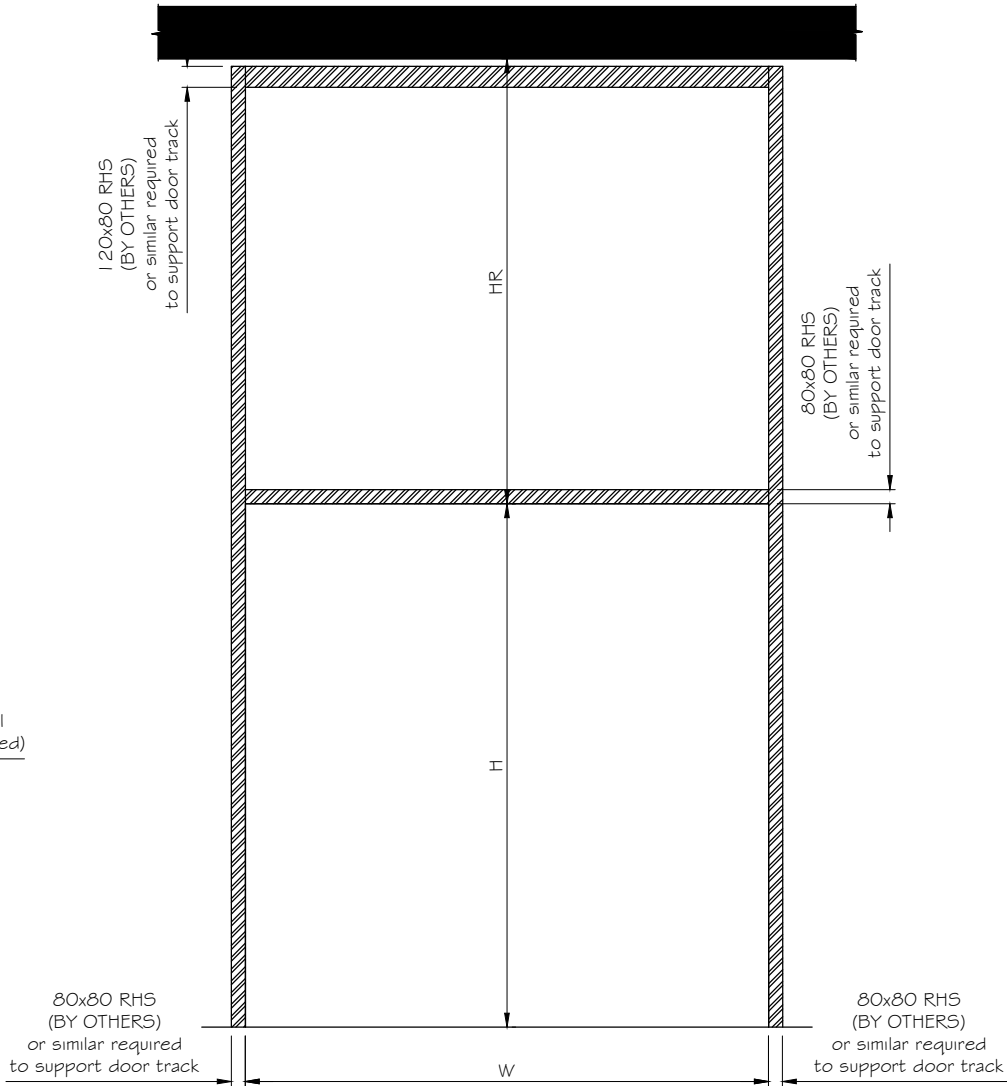

SUPPORT STEELWORK (viewed from inside)  
ALL SUPPORT STEELWORK BY OTHERS  
DOOR TRACK REMOVED FOR CLARITY

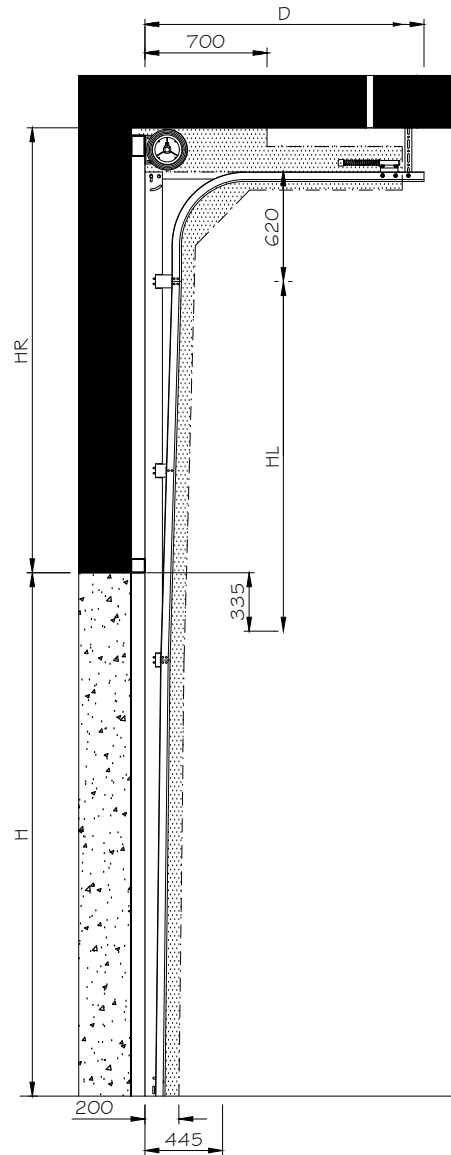

HIGH LIFT DOOR SECTION  
A-A

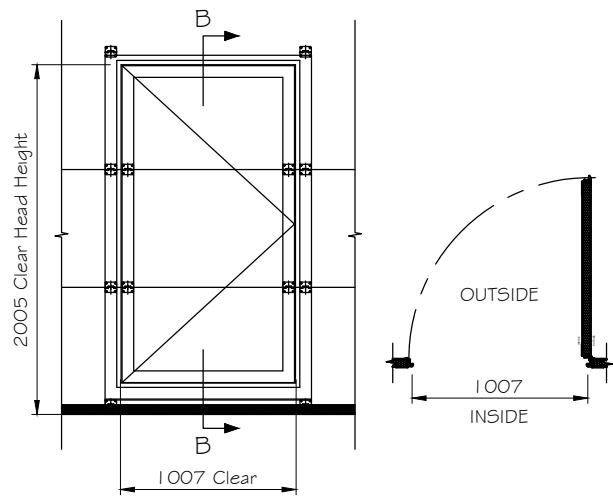

PASS DOOR (viewed from Inside)

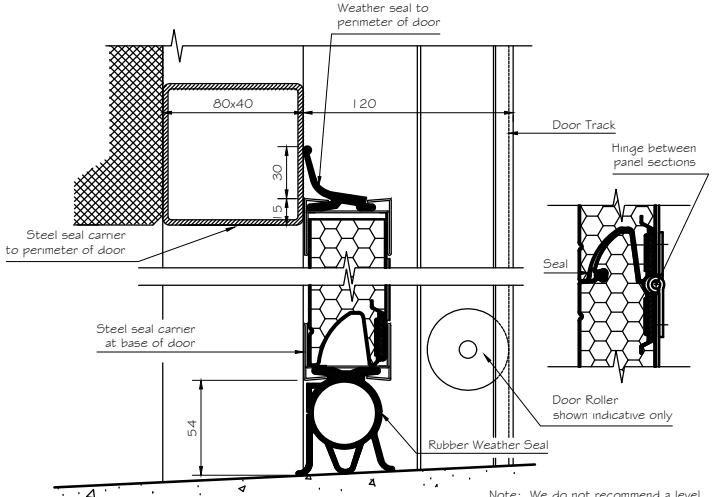

TYPICAL SEAL DETAIL

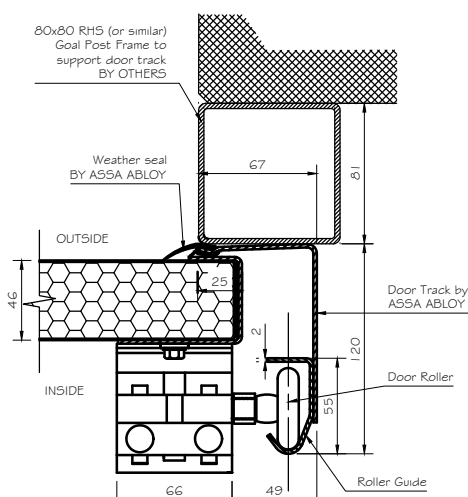

TYPICAL JAMB DETAIL

..... ° Pitched Horizontal Tracks.  
(Available in increments of 5° up to max 40°.)

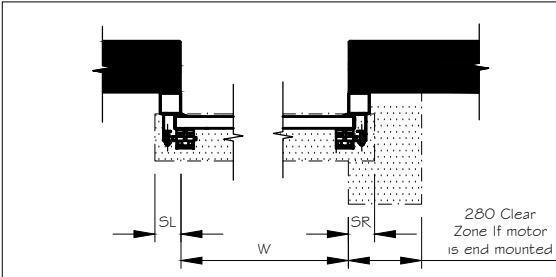

HIGH LIFT DOOR PLAN

SIZING INFORMATION		
HIGH LIFT TRACK SYSTEM (HL) Manual operation or side-mounted electrical operation.		
STRUCTURAL OPENINGS LESS THAN 7000mm		
Door Width	W	Alu < 7000 Steel < 6000 (2" Track)
Door Height	H	1500-6175
High Lift	HL	HR - 600 (Max. 3000)
Lintel to u/s Ceiling	HR	Max. 3600
Depth	D	H - HL + 600*
Vertical side space Left	SL	100***
Vertical side space Right	SR	100***
Horizontal Space	HS	130***
Clear Height	F	H + HL + 150
Pitch	T	5° - 40°

STRUCTURAL OPENINGS GREATER THAN 7000mm		
Door Width	W	Alu > 7000 Steel > 6000 (3" Track)
Door Height	H	1500-6175
High Lift	H	HR - 600 (Max. 3000mm)
Lintel to u/s Ceiling	HR	Max. 3600
Depth	D	H - HL + 600*
Vertical side space Left	SL	100**
Vertical side space Right	SR	100**
Horizontal Space	HS	130**
Clear Height	F	H + HL + 150
Pitch	T	5° - 40°

- \* H-HL+240mm if special pull-stop is chosen
- \*\* With a wide mounted motor the required side space is 280mm on motor side.

#### SITE MEASURE INFORMATION

HIGH LIFT TRACK SYSTEM (HL) Manual operation or side-mounted electrical operation.		
Door Width	W	
Door Height	H	
High Lift	HL	
Lintel to u/s Ceiling	HR	
Depth	D	
Vertical side space Left	SL	
Vertical side space Right	SR	
Horizontal Space	HS	
Clear Height	F	
Pitch	T	

#### ADDITIONAL NOTES

DRAWN BY:	
CHECKED BY:	
DATE:	
DRAWING No.	REV.
NAS9000-HL I	

**ASSA ABLOY**

ASSA ABLOY Entrance Systems Ltd  
Industrial Door and Docking Solutions

7Churchill Way ,35A Business Park ,Chapeltown ,Sheffield ,UK ,S35 2PY  
Tel: +44 (0)114 257 4330 Fax: +44 (0)114 257 4399

TITLE:  
NASSAU 9000 HIGH LIFT  
SECTIONAL DOOR DETAILS  
timber.

Steel ☐ Timber ☐ Masonry ☐ Other ☐

CLIENT:

SITE:

DRAWING STATUS

PRELIMINARY

FOR APPROVAL

CONSTRUCTION

AS BUILT

REV.

BY

DATE

COMMENT

