

Automatic Curved sliding door system CD Concave

Design:
Fully automatic double-leaf curved convex sliding door with self-learning 32 bit door control system; low-noise, long-life door leaf guides, start impulse via motion detector; sensor protection incl. overcurrent detection; i-record connection via bluetooth

Dimensions:
Inside Radius IR : from 800 [mm]
Side part radius STR : IR+23 [mm]
Passage width A : from 1000 [mm]
Passage height G : 2200-3000 [mm]
Total height J : 2400-3300 [mm]
Profile system ALU 20 width [mm]
The possibility of constructing a door with dimensions outside the specified ranges can be discussed individually

Glass:
Profile system 20 [mm] - 9,52 [mm] max. glass thickness

Glass types:
• Laminated safety glass
• Insulated glass
• P4A and P5A for RC2/RC3

BDE-D flush mount as standard

Options:

Purposes:
• Standard
• Escape and rescue route

Surface options:
• Raw/untreated Aluminium
• Aluminium powder coating
• Anodized Aluminium
• Cladding (stainless steel/brass/bronze/etc.)

Floor Guide:

• Finished floor
• Floor guide rail
• Floor ring

Mechanical options:

• Air curtain (dependent on other options)
• Locking device
• Roof options:
◦ White coated chipboard
◦ Dust roof cover
◦ Metall dust roof cover

Electrical options:

• Input for fire alarm
• Door position contact "closed"
• Lock monitoring contact
• Uninterrupted power supply
• LED build-in Lights
• Emergency stop switch
• Emergency opening switch
• Battery pack
• Control unit BDE-D surface mount (flush mount as standard)
• Key operating switch BDE-V

Surface treatment		Material		Remark	
General tolerance		Proj. method		Scale	
ISO 2768		HNU		1:10	
Description		Drawn		Date	
ASSA ABLOY		CD Concave - ALU 20 [mm]		Status	
Drawing No.		Rev.		Size	
		A		A0	
				Sheet	
				1 (3)	

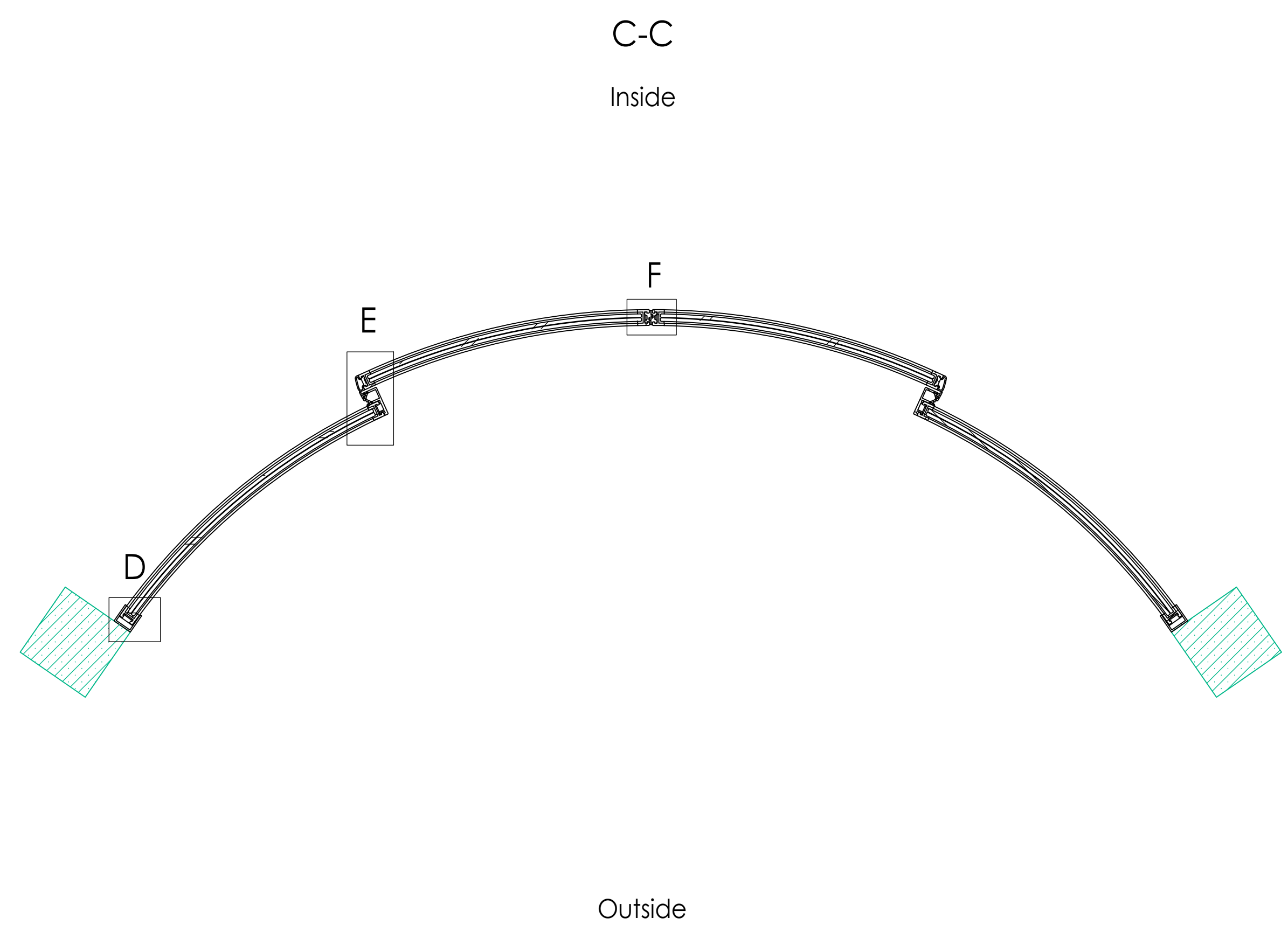
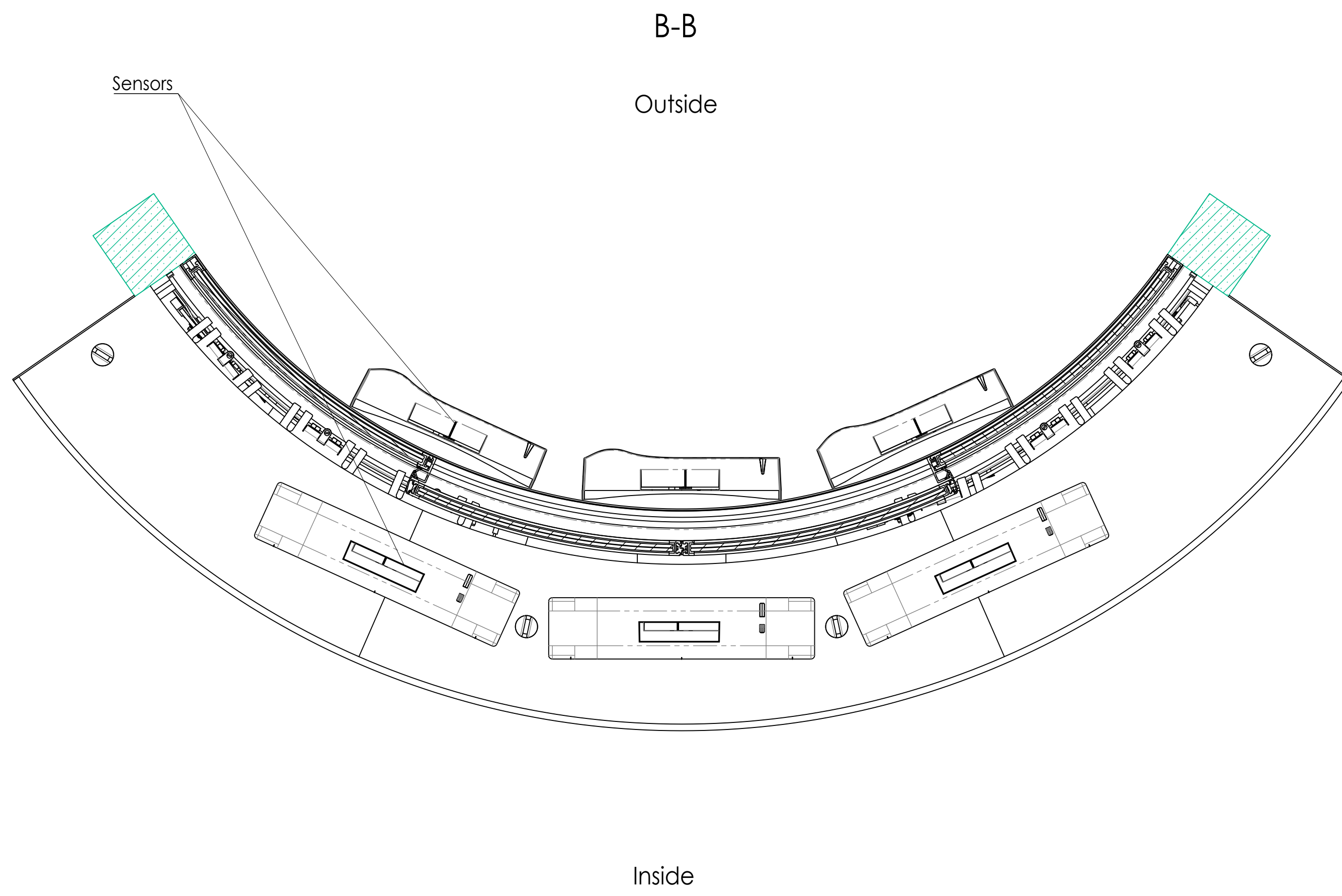
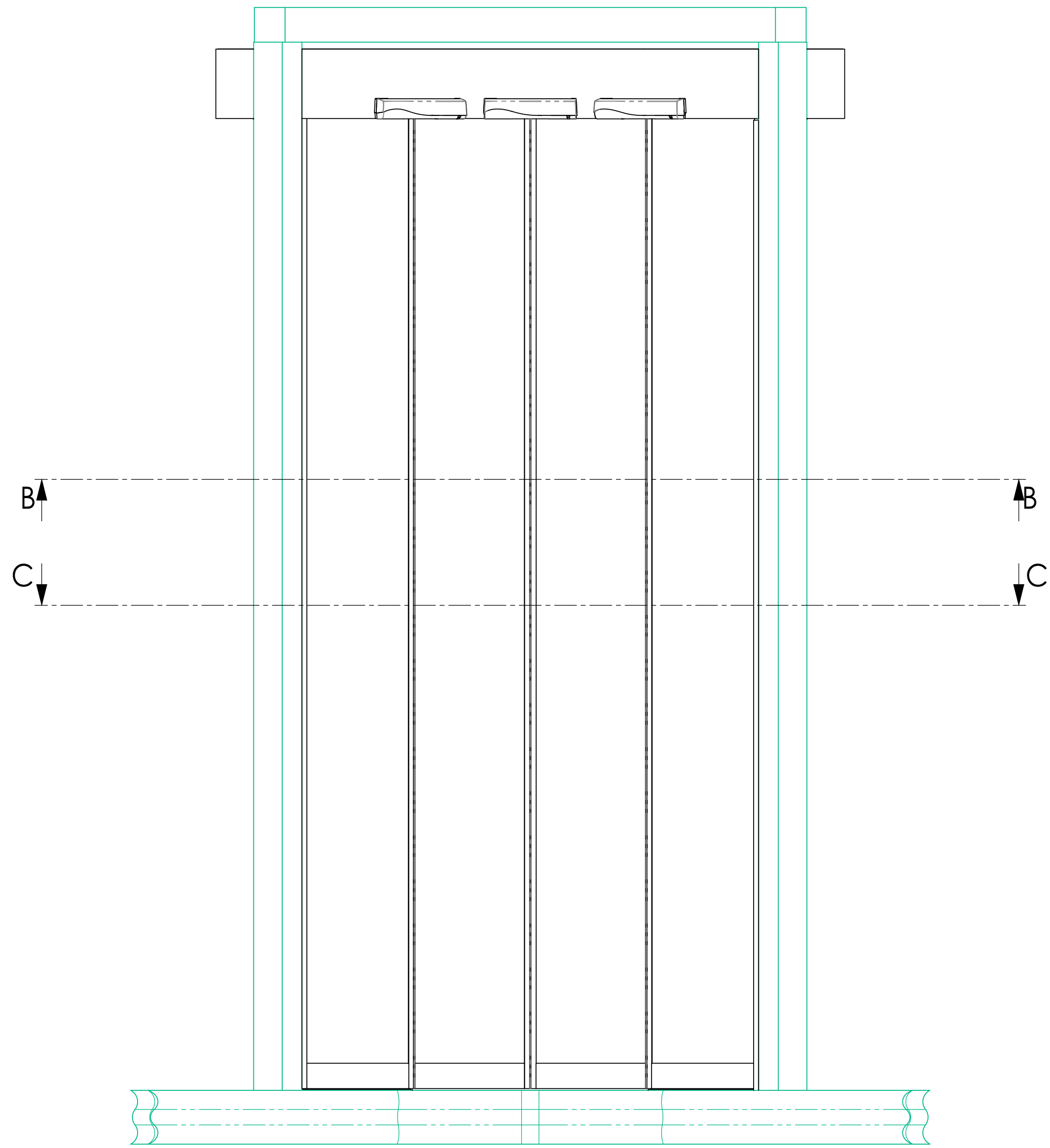

Main + Secondary closing edge

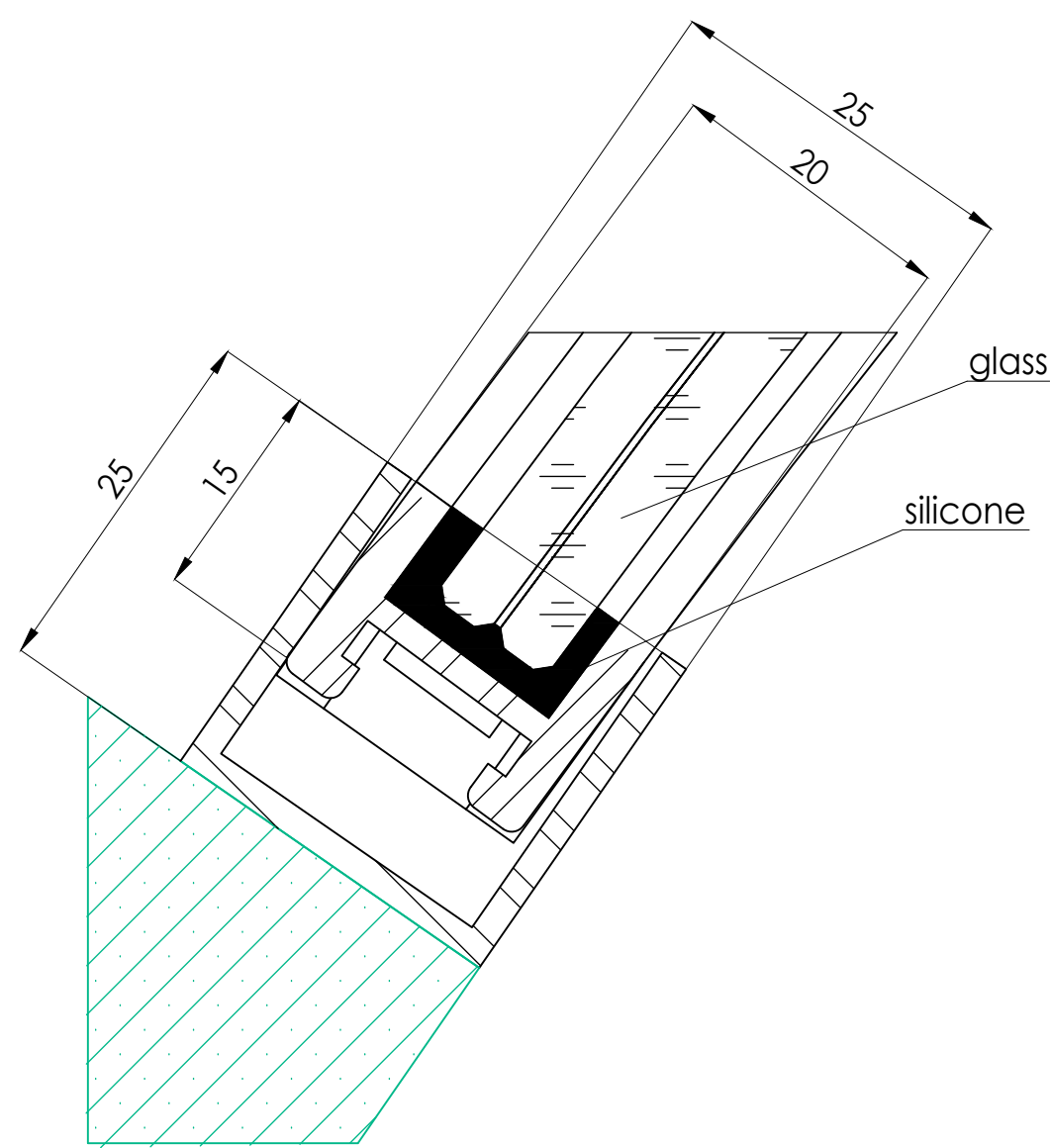

D
(2 : 1)

(Facade connection to be defined by customer)

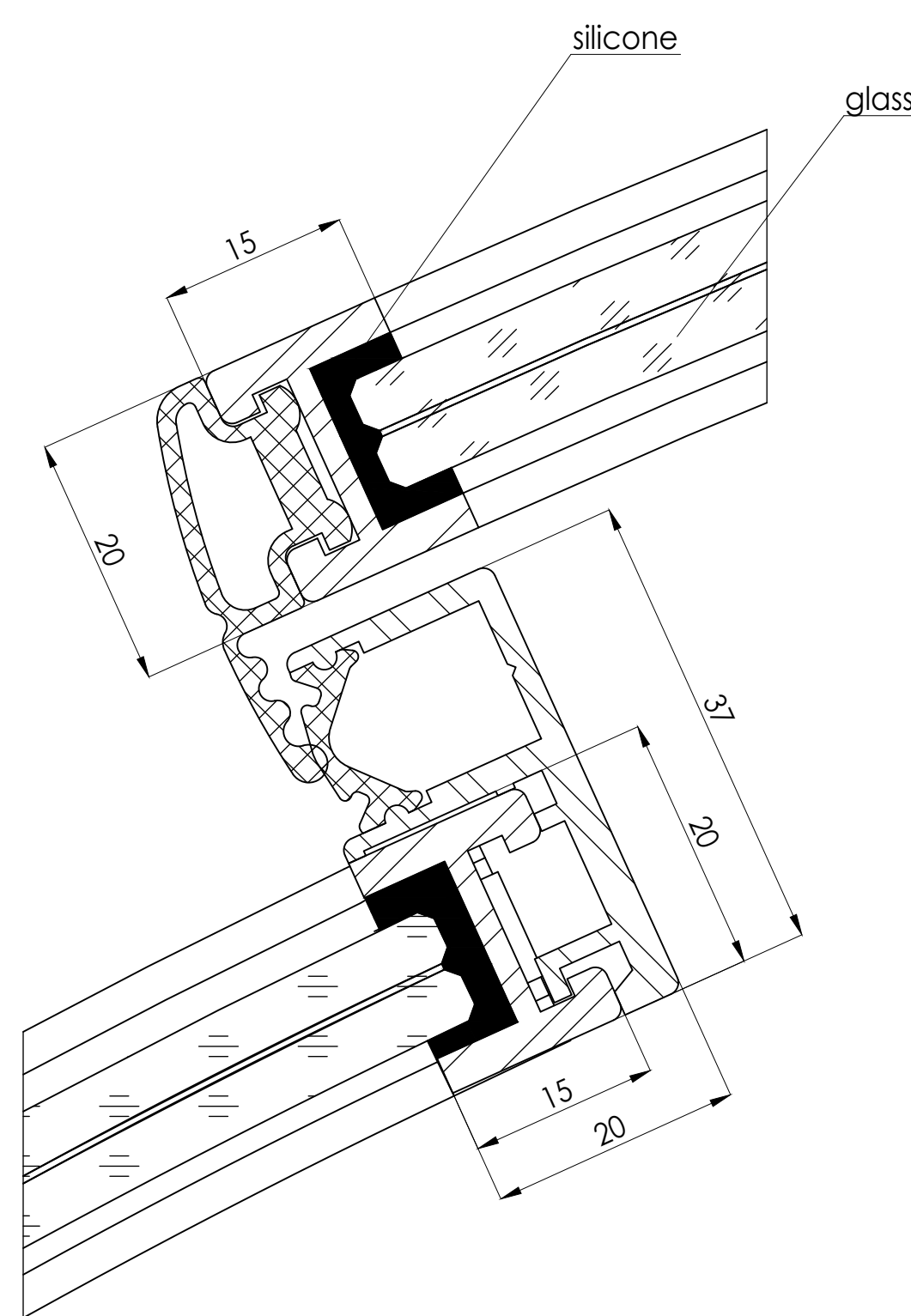

E
(2 : 1)

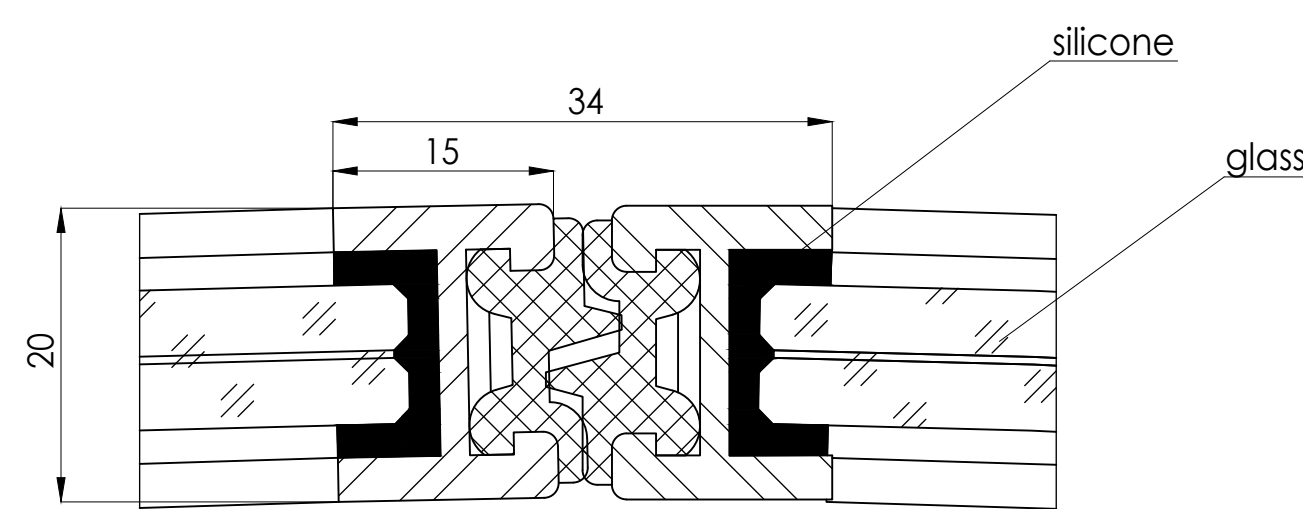

F
(2 : 1)

Surface treatment		Material		Remark	
General tolerance		Scale		Status	
ISO 2768		1:10		Approved	
Description		Drawn		Date	
ASSA ABLOY		HNNU		2022-11-18	
Drawing No.		Rev.		A	
		Size		A0	
		Sheet		2 (3)	

Floor guide

Top view floor ring

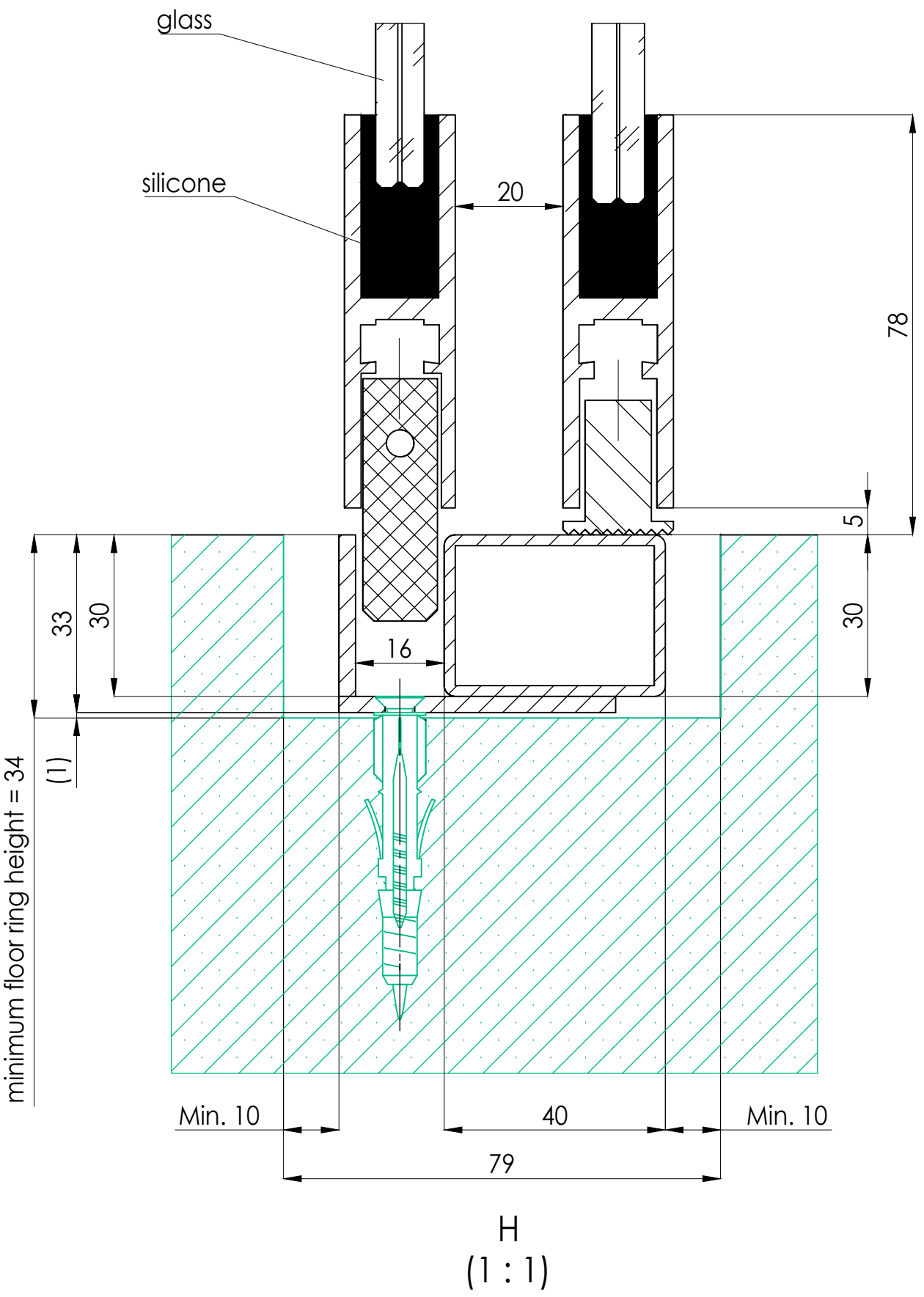
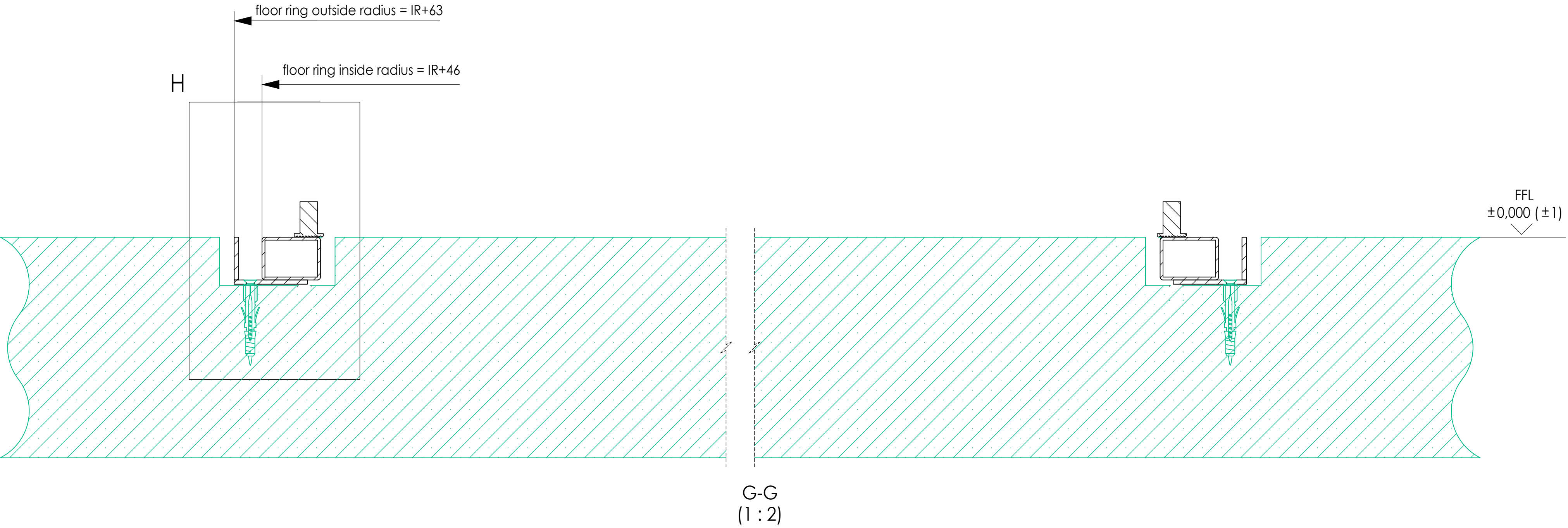
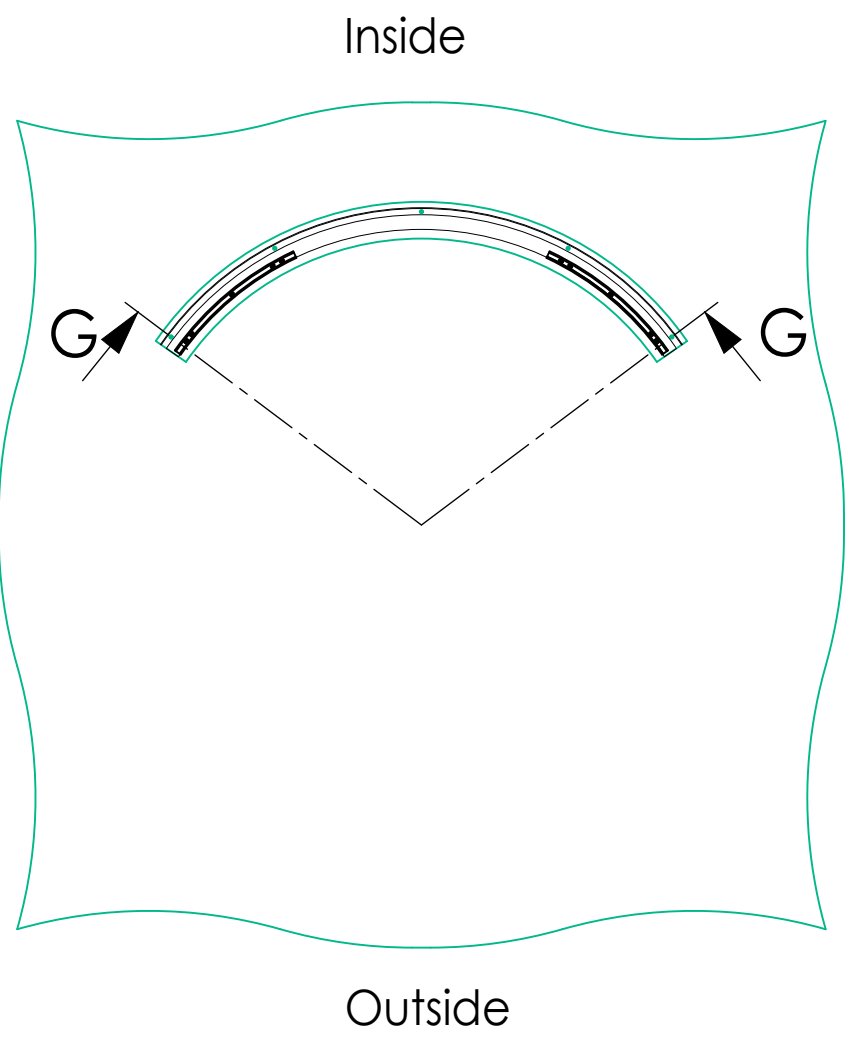

Top view floor guide rail

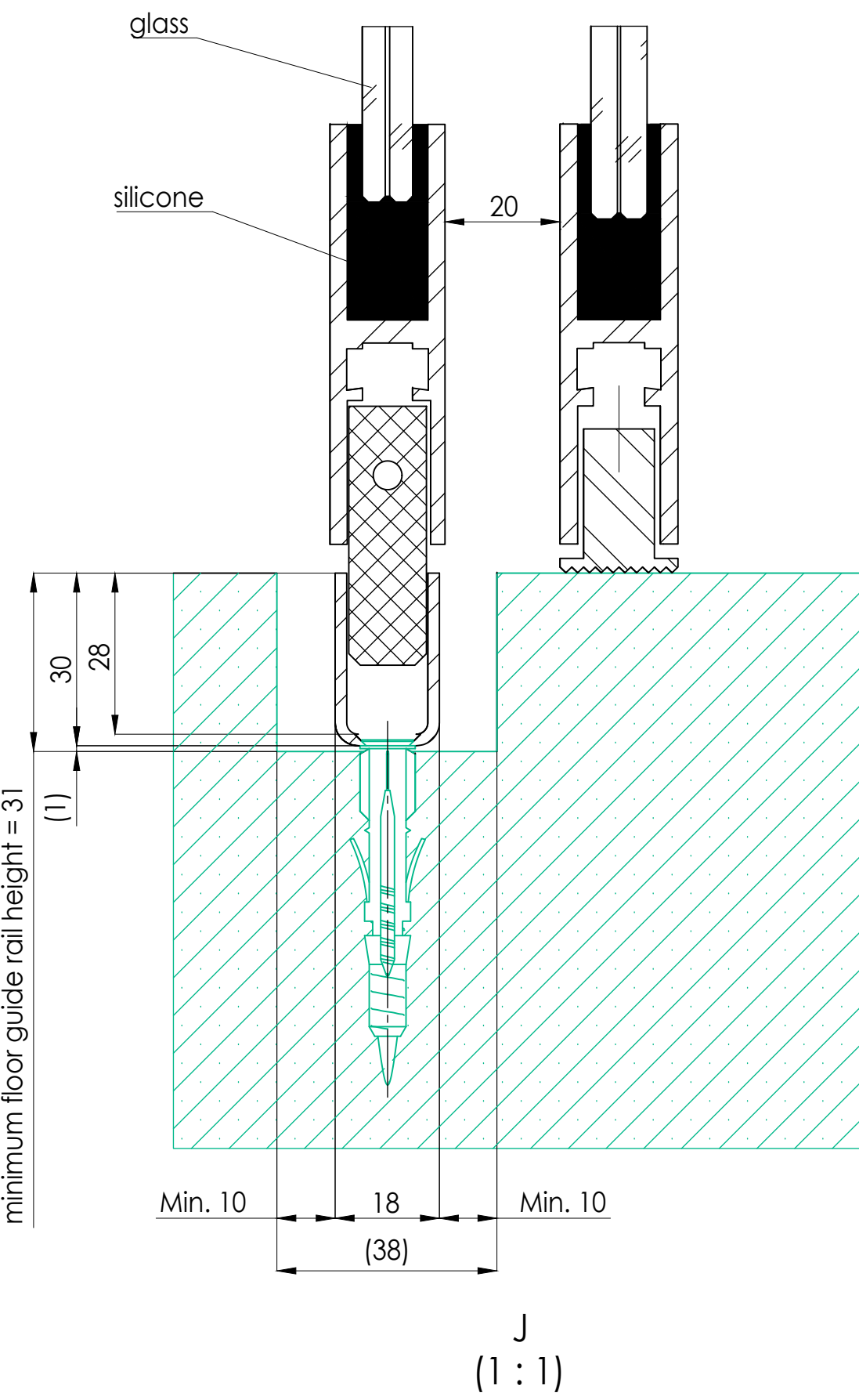
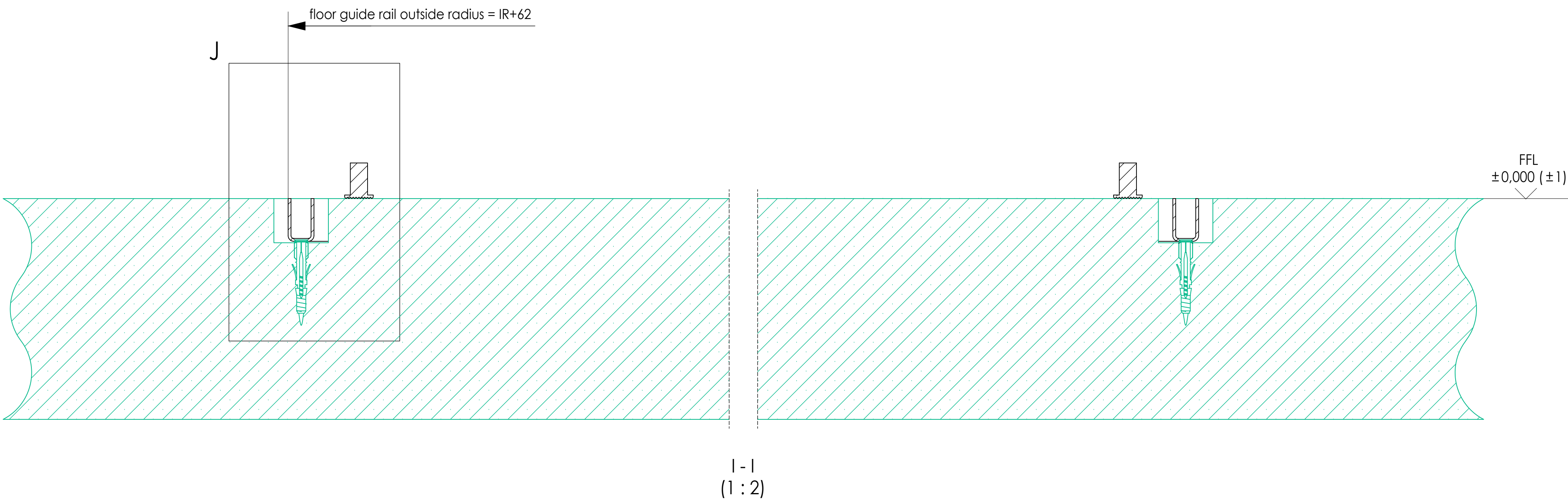
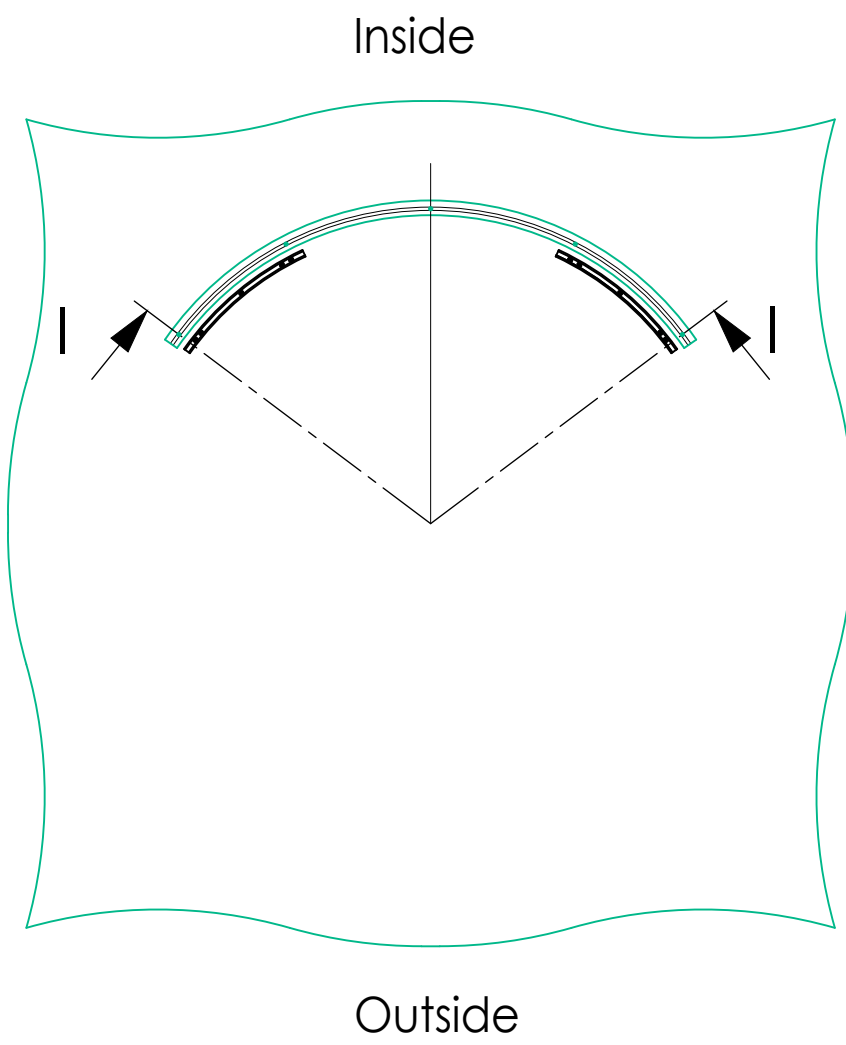

Top view finished floor

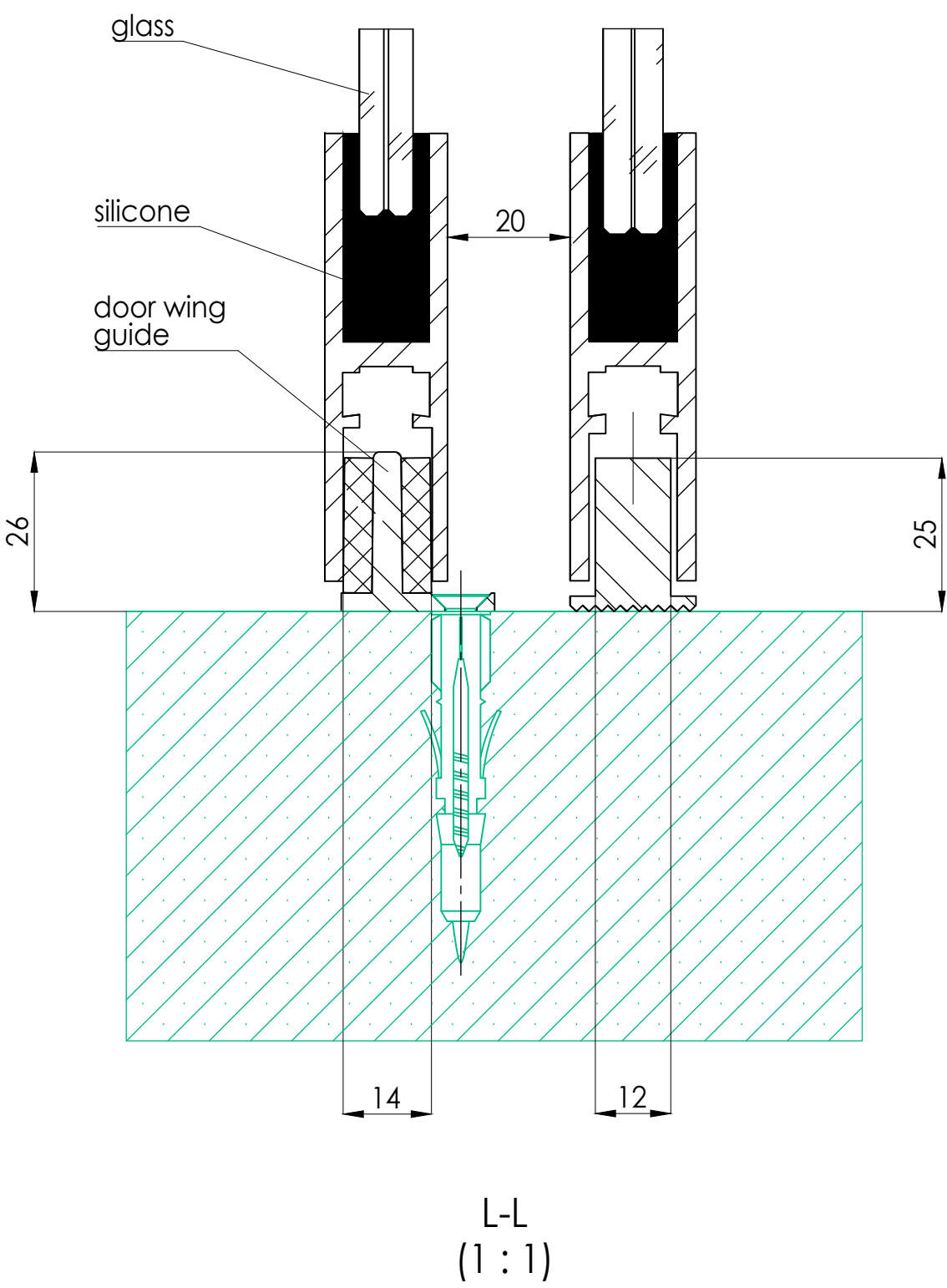
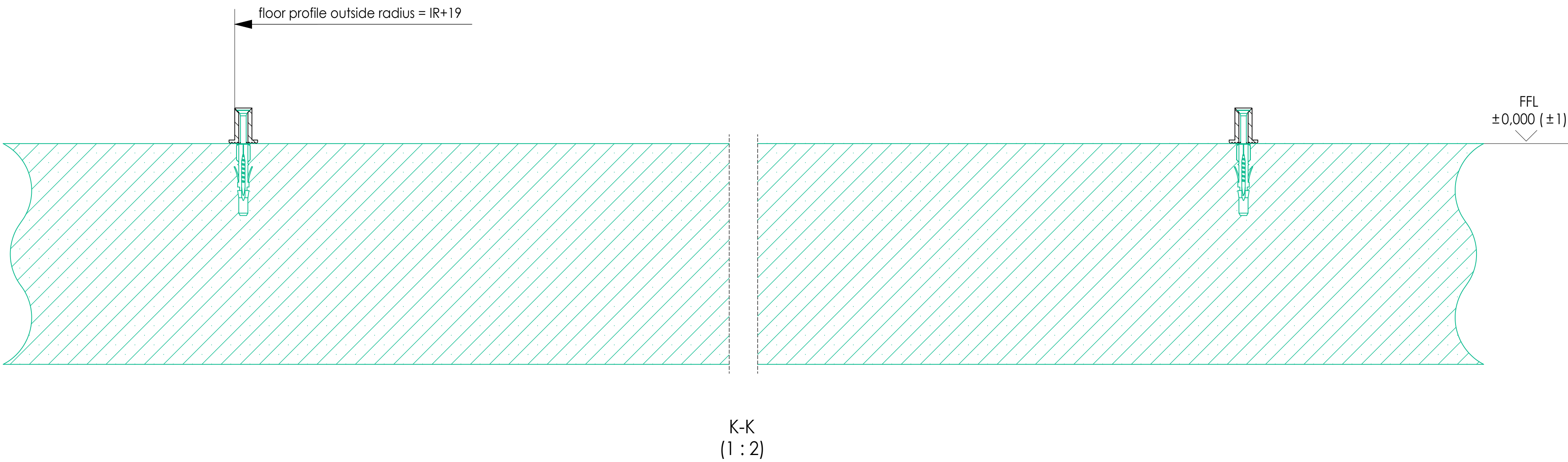
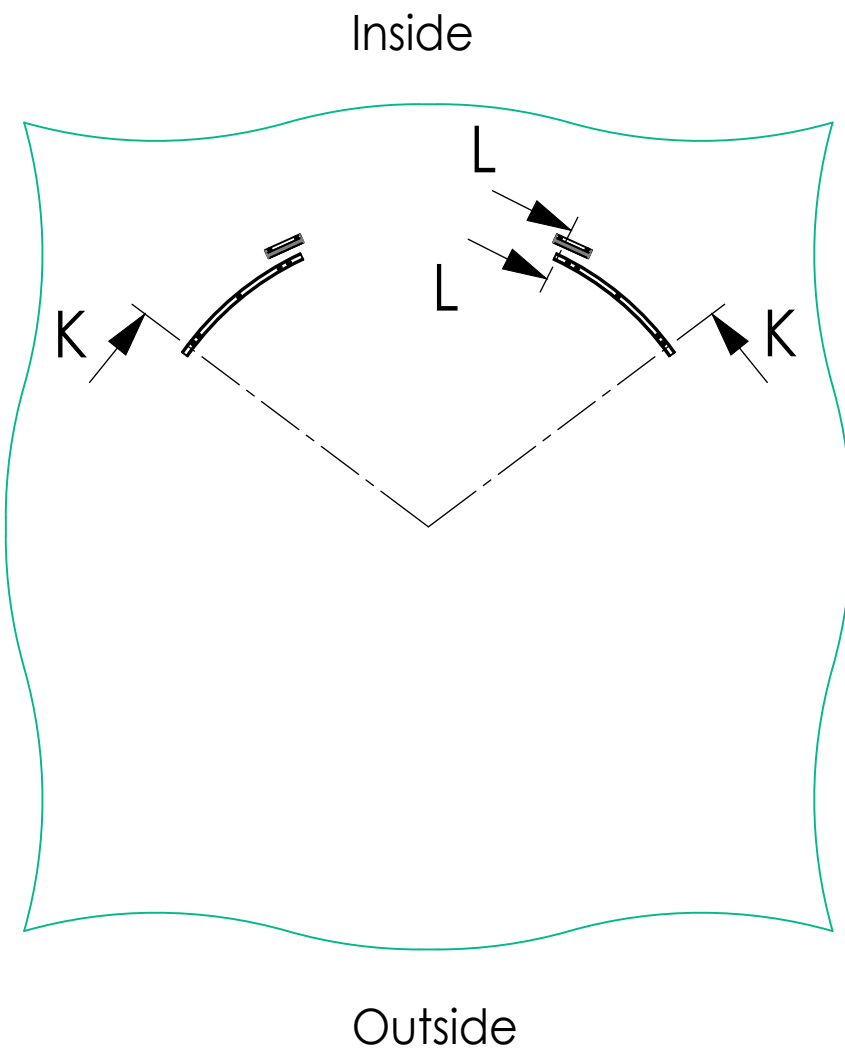

Surface treatment		Material		Remark		
General tolerance		Scale		Status		
ISO 2768		1:20		Approved		
Description		Drawn		Rev.		
ASSA ABLOY		HNU		A		
Drawing No.		Date		Size		
		2022-11-18		A0		
				Sheet		
				3 (3)		