

STATE WHEN ORDERING

FW = mm
FH = mm
COW = mm
COH = mm
CL = mm

Surface treatment

☐ Silver anodized
Special anodized
RAL
Special powder coating
.....

Options see layers:

☐ Bottom rail 178
☐ Frame Eco
☐ Midrail 70, MH = mm
☐ Midrail 150, MH = mm
☐ Threshold floor guide, L = 2FW + 44
☐ TightSeal (floor level difference max. ± 3 mm)

☐ Glass option see drw. 1009026

Glass code:

☐ Infill panel:

Combination of glass and infill panel.

Midrail must be selected and the infill panel will be placed below the midrail. Choose glass type above. The thickness of the infill panel will correspond with the glass thickness (6 or 10 mm glass will generate 8 mm panel)

Installation

☐ Floor heating
☐ Sensor
☐ Other

Notes:

Customer:

Ref:

Door id:

Date:

Project No:

Sign:

Automatic door system
ASSA ABLOY Frame 1 Panel wall mounted opening left
Art. No. 1009380-1PS-15
ASSA ABLOY SL500

ASSA ABLOY

8.0

1009380-en

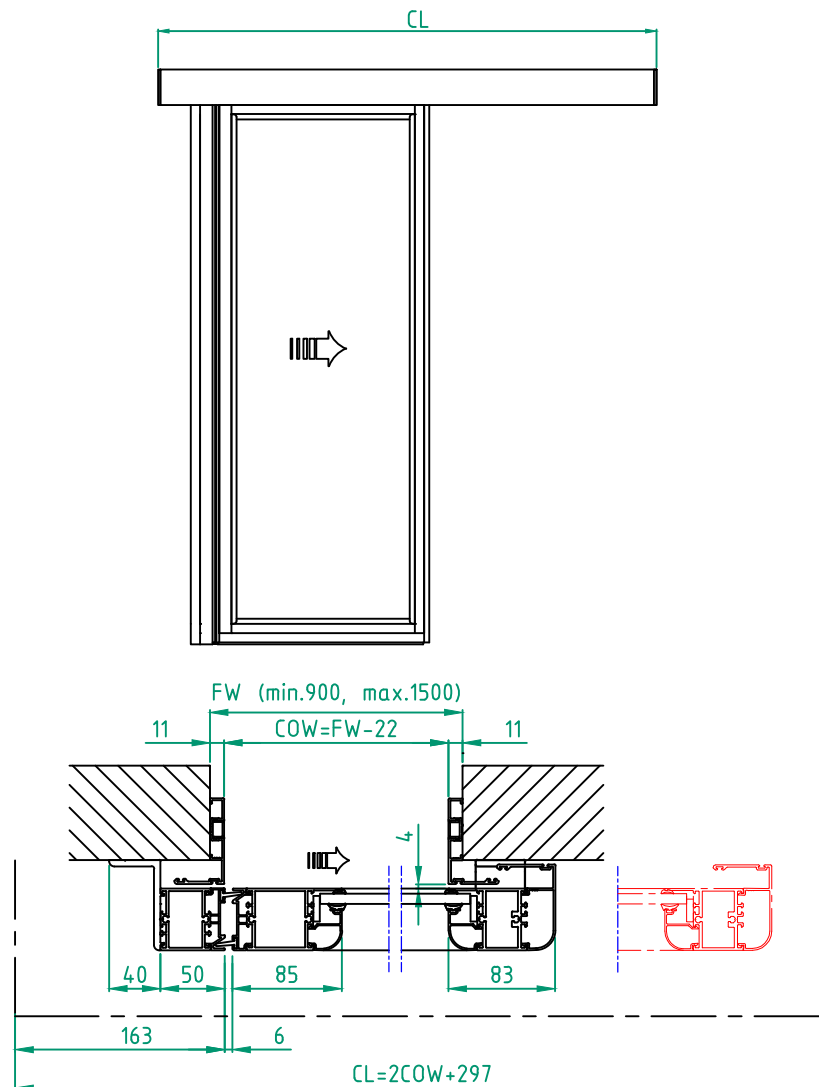
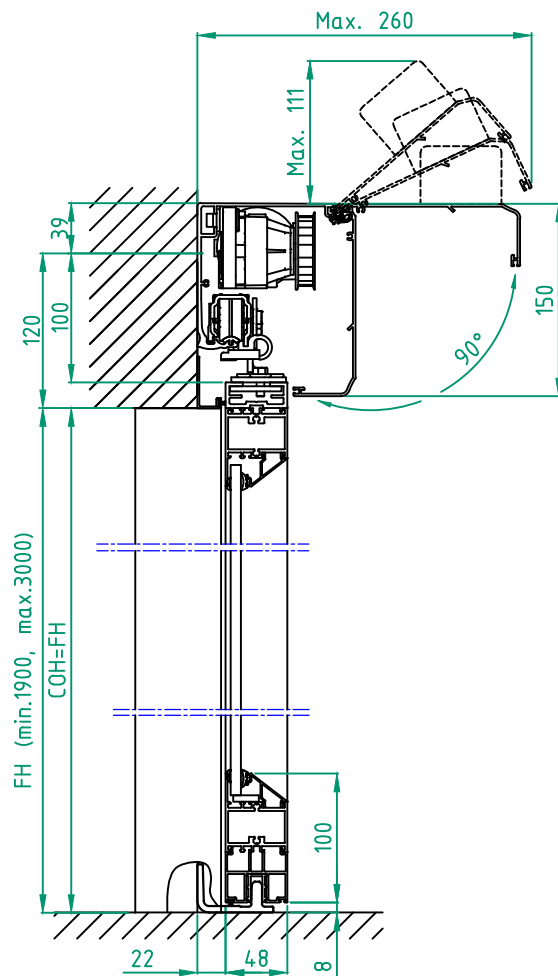

STATE WHEN ORDERING

FW = mm
FH = mm
COW = mm
COH = mm
CL = mm

Surface treatment

☐ Silver anodized
Special anodized
RAL
Special powder coating
.....

Options see layers:

☐ Bottom rail 178
☐ Frame Eco
☐ Midrail 70, MH = mm
☐ Midrail 150, MH = mm
☐ Threshold floor guide, L = 2FW + 44
☐ TightSeal (floor level difference max. ± 3 mm)

☐ Glass option see drw. 1009026

Glass code:

☐ Infill panel:

Combination of glass and infill panel.
Midrail must be selected and the infill panel will be placed below the midrail. Choose glass type above. The thickness of the infill panel will correspond with the glass thickness (6 or 10 mm glass will generate 8 mm panel)

Installation

☐ Floor heating
☐ Sensor
☐ Other

Notes:

Customer:

Ref:

Door id:

Date:

Project No:

Sign:

Automatic door system
ASSA ABLOY Frame 1 Panel wall mounted opening right

Art. No. 1009380-1PS-15

ASSA ABLOY SL500

ASSA ABLOY

8.0

1009380-en

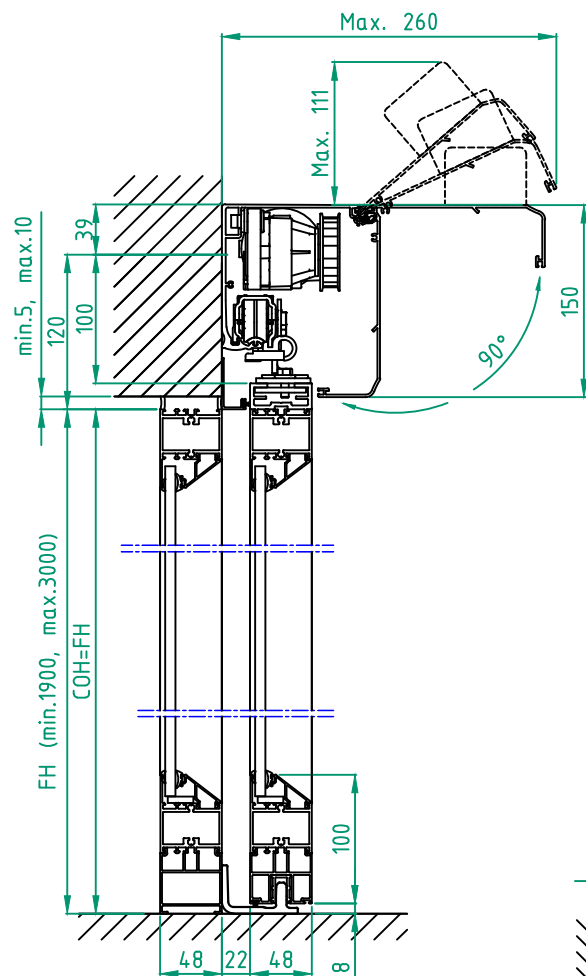

Notes:

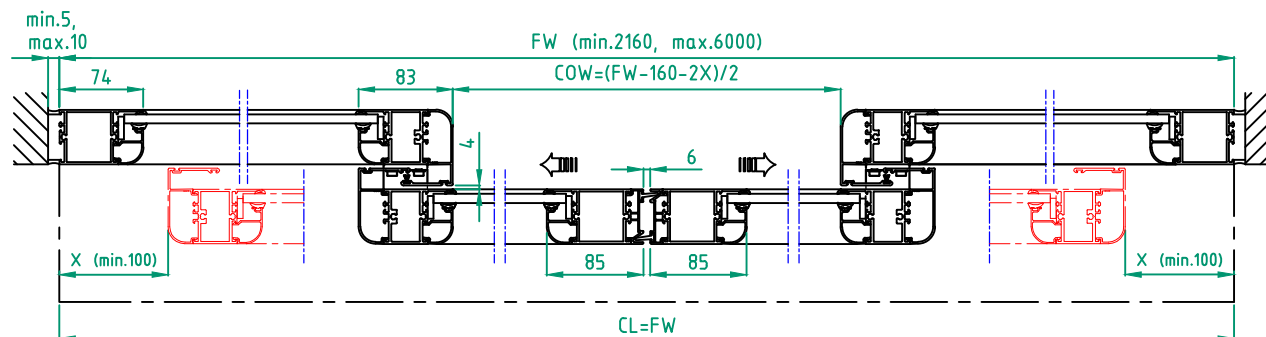
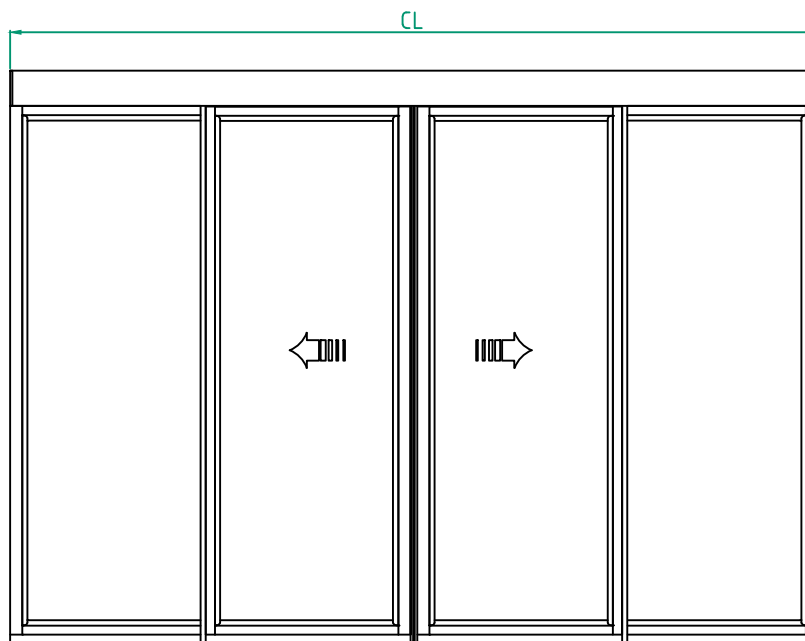

STATE WHEN ORDERING

FW = mm
FH = mm
X = mm
COW = mm
COH = mm
CL = mm
Surface treatment
☐ Silver anodized
☐ Special anodized
RAL
☐ Special powder coating

Options see layers:

☐ Bottom rail 178
☐ Frame Eco
☐ Midrail 70, MH = mm
☐ Midrail 150, MH = mm
☐ Threshold floor guide, L = FW
☐ TightSeal (floor level difference max. ± 3 mm)

☐ Glass option see drw. 1009026

Glass code:

☐ Infill panel:

Combination of glass and infill panel.
Midrail must be selected and the infill panel will be placed below the midrail. Choose glass type above. The thickness of the infill panel will correspond with the glass thickness (6 or 10 mm glass will generate 8 mm panel)

Installation

☐ Floor heating
☐ Sensor
☐ Other

Customer:

Ref:

Door id:

Date:

Project No:

Sign:

Automatic door system
ASSA ABLOY Frame 4 Panel wall mounted
Art. No. 1009380-4PB-15
ASSA ABLOY SL500

ASSA ABLOY

8.0

1009380-en

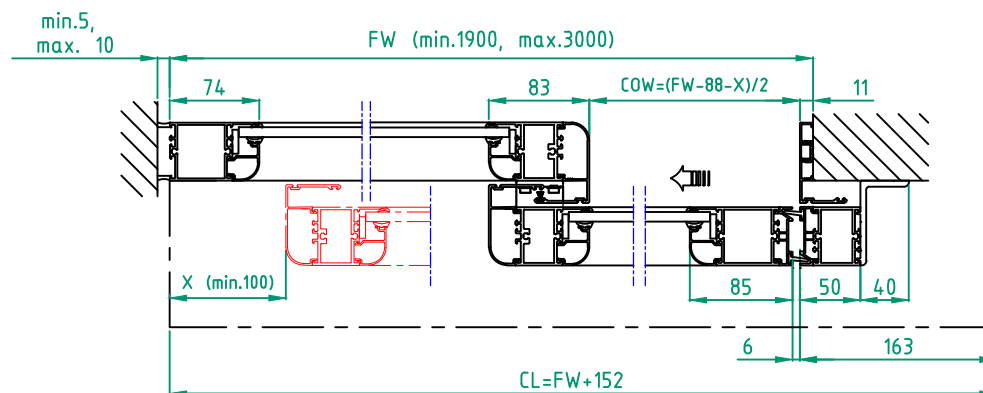
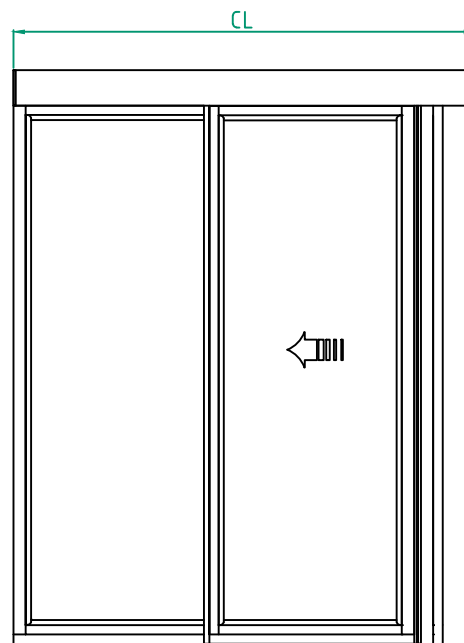
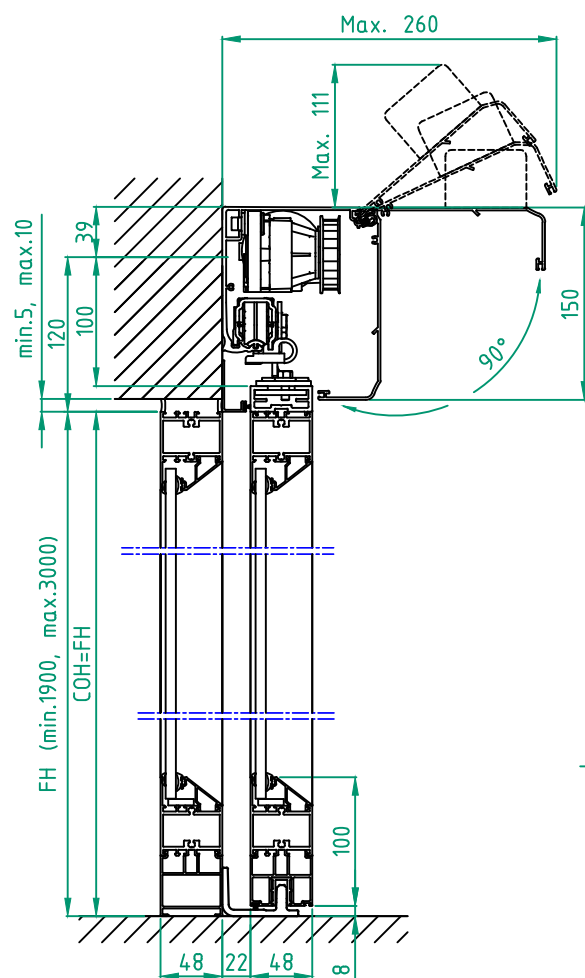

STATE WHEN ORDERING

FW = mm
FH = mm
X = mm
COW = mm
COH = mm
CL = mm

Surface treatment

☐ Silver anodized
☐ Special anodized
RAL
☐ Special powder coating
.....

Options see layers:

☐ Bottom rail 178
☐ Frame Eco
☐ Midrail 70, MH = mm
☐ Midrail 150, MH = mm
☐ Threshold floor guide, L = FW
☐ TightSeal (floor level difference max. ± 3 mm)

☐ Glass option see drw. 1009026

Glass code:

☐ Infill panel:

Combination of glass and infill panel.
Midrail must be selected and the infill panel will be placed below the midrail. Choose glass type above. The thickness of the infill panel will correspond with the glass thickness (6 or 10 mm glass will generate 8 mm panel)

Installation

☐ Floor heating
☐ Sensor
☐ Other

Notes:

Customer:

Ref:

Door id:

Date:

Project No:

Sign:

Automatic door system
ASSA ABLOY Frame 2 Panel wall mounted opening left
Art. No. 1009380-2PS-15
ASSA ABLOY SL500

ASSA ABLOY

8.0

1009380-en

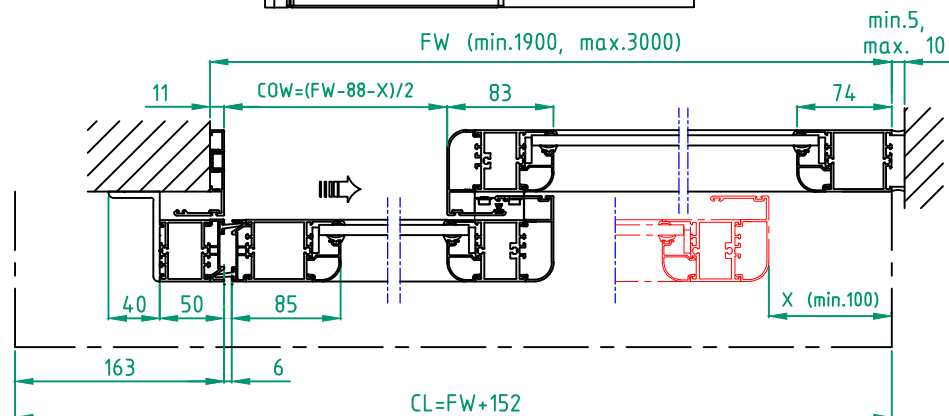
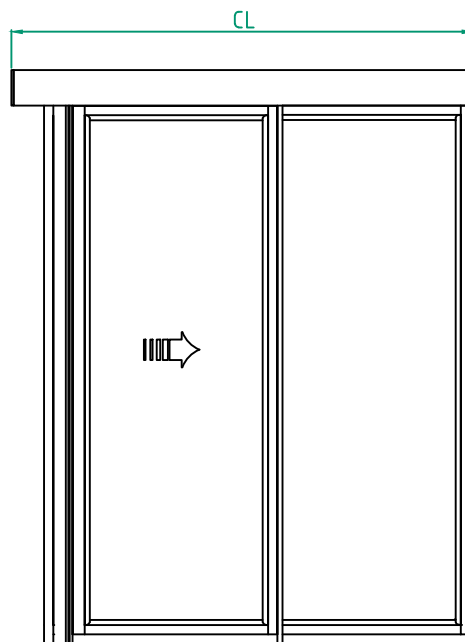
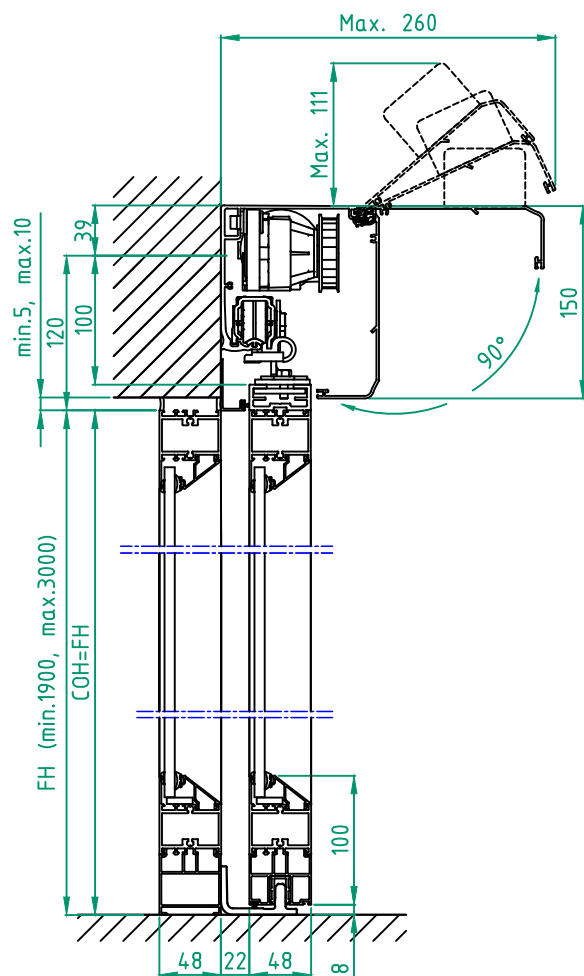

STATE WHEN ORDERING

FW = mm
FH = mm
X = mm
COW = mm
COH = mm
CL = mm

Surface treatment

☐ Silver anodized
Special anodized
RAL
Special powder coating
.....

Options see layers:

☐ Bottom rail 178
☐ Frame Eco
☐ Midrail 70, MH = mm
☐ Midrail 150, MH = mm
☐ Threshold floor guide, L = FW
☐ TightSeal (floor level difference max. ± 3 mm)

☐ Glass option see drw. 1009026

Glass code:

☐ Infill panel:

Combination of glass and infill panel.
Midrail must be selected and the infill panel will be placed below the midrail. Choose glass type above. The thickness of the infill panel will correspond with the glass thickness (6 or 10 mm glass will generate 8 mm panel)

Installation

☐ Floor heating
☐ Sensor
☐ Other

Notes:

Customer:

Ref:

Door id:

Date:

Project No:

Sign:

Automatic door system
ASSA ABLOY Frame 2 Panel wall mounted opening right
Art. No. 1009380-2PS-15
ASSA ABLOY SL500

ASSA ABLOY

8.0

1009380-en

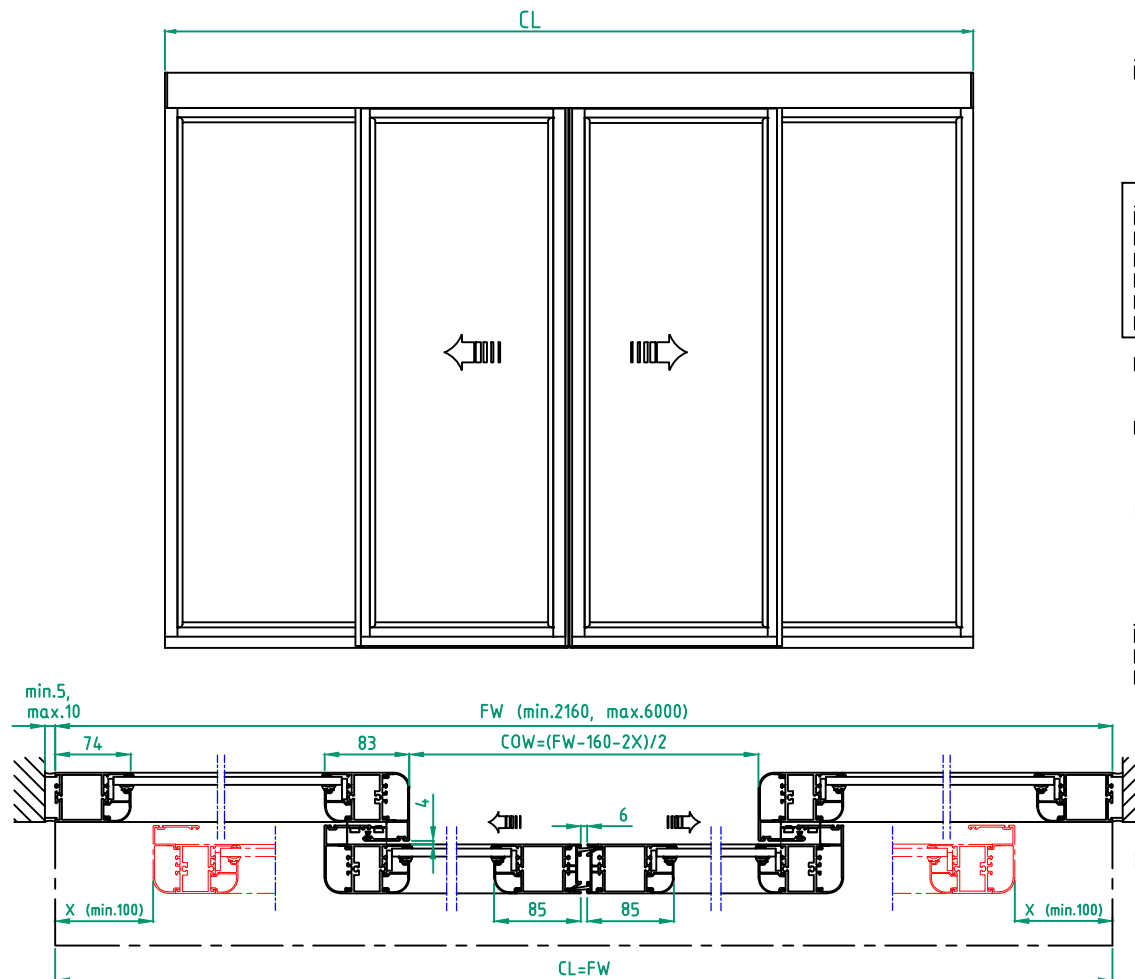
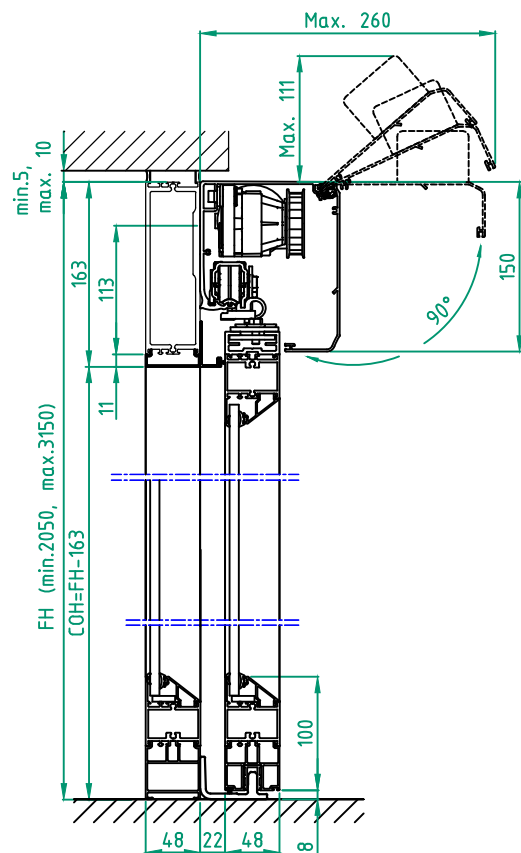

STATE WHEN ORDERING

FW = mm
FH = mm
X = mm
COW = mm
COH = mm
CL = mm

Surface treatment

☐ Silver anodized
Special anodized
RAL
Special powder coating
.....

Options see layers:

☐ Bottom rail 178
☐ Frame Eco
☐ Midrail 70, MH = mm
☐ Midrail 150, MH = mm
☐ Threshold floor guide, L = FW
☐ TightSeal (floor level difference max. ± 3 mm)

☐ Glass option see drw. 1009026

Glass code:

☐ Infill panel:

Combination of glass and infill panel.

Midrail must be selected and the infill panel will be placed below the midrail. Choose glass type above. The thickness of the infill panel will correspond with the glass thickness (6 or 10 mm glass will generate 8 mm panel)

Installation

☐ Floor heating
☐ Sensor
☐ Other

Notes:

Customer:

Ref:

Door id:

Date:

Project No:

Sign:

Automatic door system
ASSA ABLOY Frame 4 Panel beam mounted
Art. No. 1009380-4PB-15
ASSA ABLOY SL500

ASSA ABLOY

8.0

1009380-en

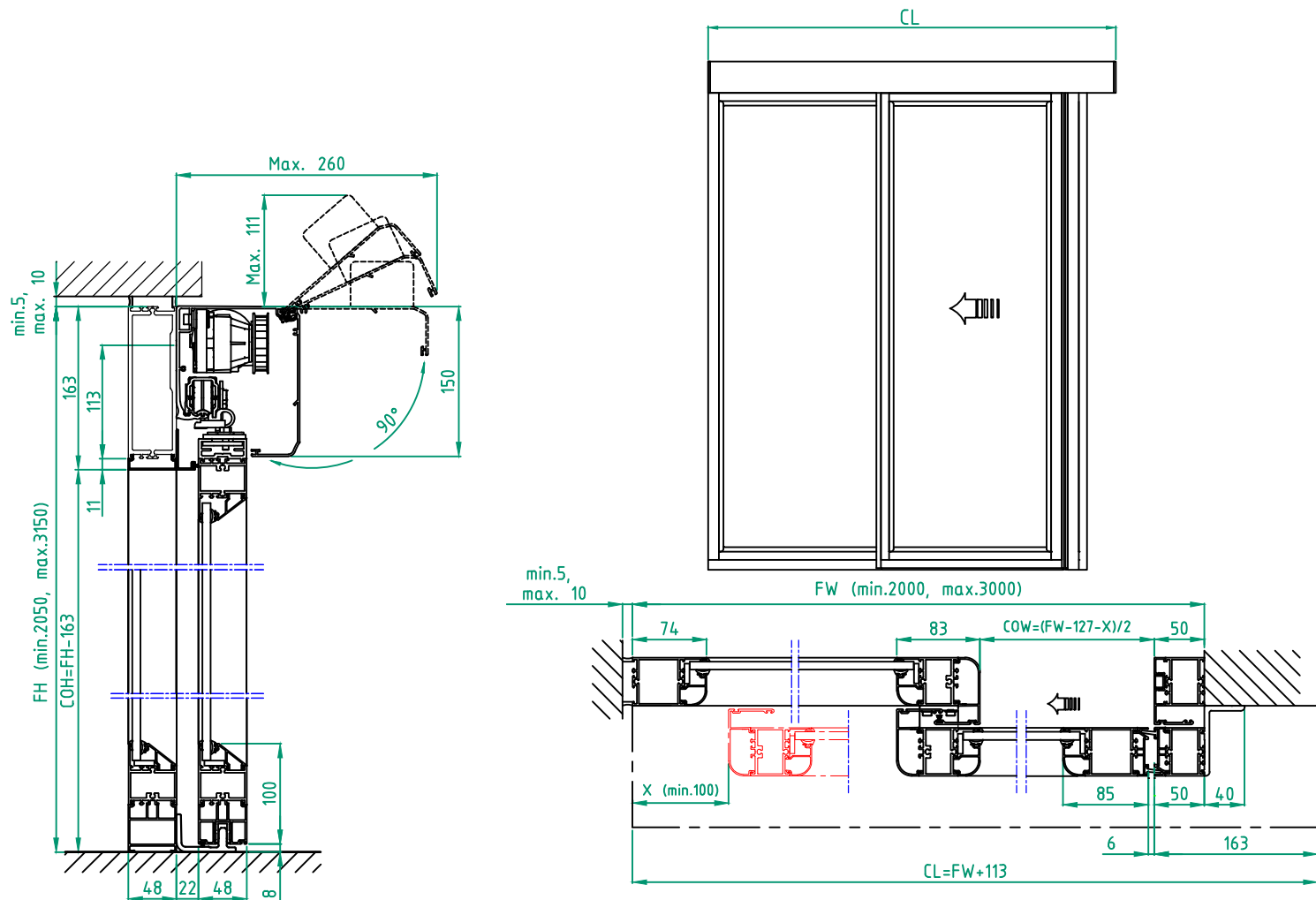

STATE WHEN ORDERING

FW = mm
 FH = mm
 X = mm
 COW = mm
 COH = mm
 CL = mm

Surface treatment

☐ Silver anodized
☐ Special anodized
 RAL
☐ Special powder coating

Options see layers:

☐ Bottom rail 178
☐ Frame Eco
☐ Midrail 70, MH = mm
☐ Midrail 150, MH = mm
☐ Threshold floor guide, L = FW
☐ TightSeal (floor level difference max. ± 3 mm)

☐ Glass option see drw. 1009026

Glass code:

☐ Infill panel:

Combination of glass and infill panel.
 Midrail must be selected and the infill panel will be placed below the midrail. Choose glass type above. The thickness of the infill panel will correspond with the glass thickness (6 or 10 mm glass will generate 8 mm panel)

Installation

☐ Floor heating
☐ Sensor
☐ Other

Notes:

| | | |
|-------------|-------|--|
| Customer: | Ref: | Automatic door system ASSA ABLOY Frame 2 Panel beam mounted opening left Art. No. 1009380-2PS-15 ASSA ABLOY SL500 |
| Door id: | Date: | |
| Project No: | Sign: | |

ASSA ABLOY

8.0 1009380-en

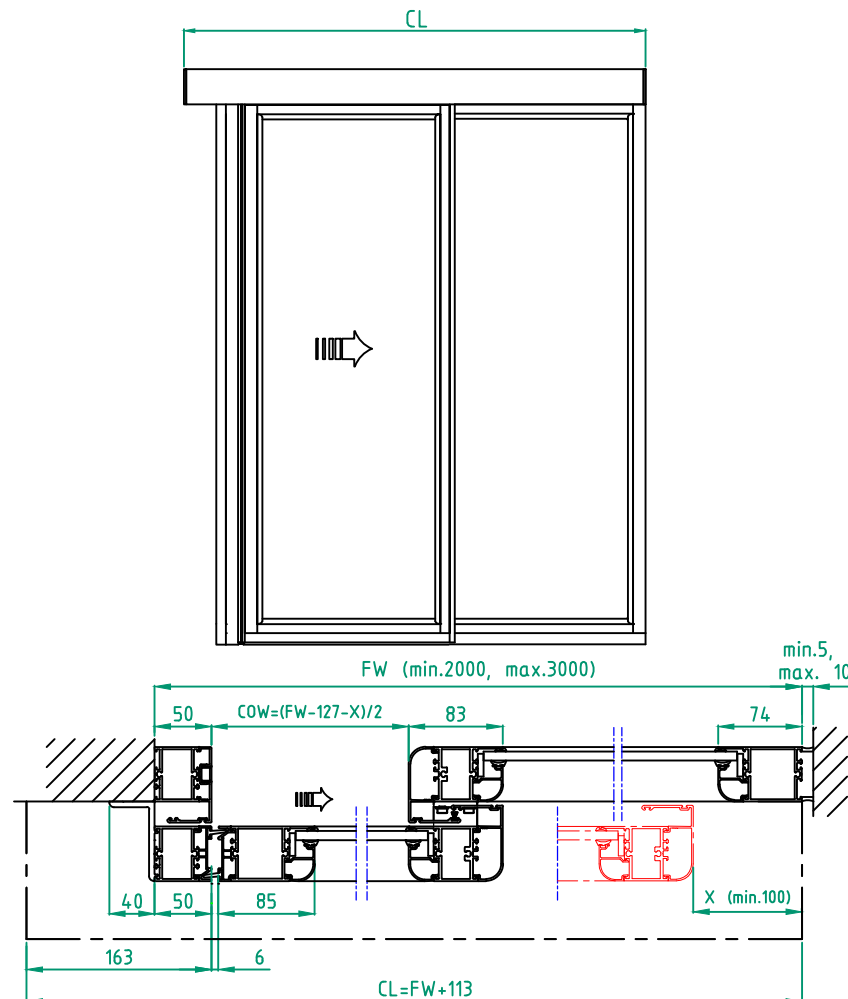
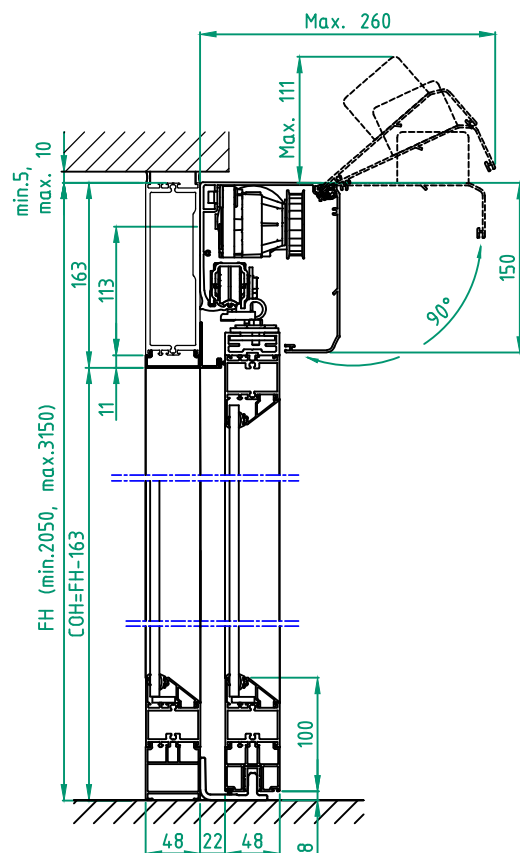

STATE WHEN ORDERING

FW = mm
FH = mm
X = mm
COW = mm
COH = mm
CL = mm

Surface treatment

☐ Silver anodized
Special anodized
RAL
Special powder coating
.....

Options see layers:

☐ Bottom rail 178
☐ Frame Eco
☐ Midrail 70, MH = mm
☐ Midrail 150, MH = mm
☐ Threshold floor guide, L = FW
☐ TightSeal (floor level difference max. ± 3 mm)

☐ Glass option see drw. 1009026

Glass code:

☐ Infill panel:

Combination of glass and infill panel.
Midrail must be selected and the infill panel will be placed below the midrail. Choose glass type above. The thickness of the infill panel will correspond with the glass thickness (6 or 10 mm glass will generate 8 mm panel)

Installation

☐ Floor heating
☐ Sensor
☐ Other

Notes:

Customer:

Ref:

Door id:

Date:

Project No:

Sign:

Automatic door system
ASSA ABLOY Frame 2 Panel beam mounted opening right
Art. No. 1009380-2PS-15
ASSA ABLOY SL500

ASSA ABLOY

8.0

1009380-en